

## Development Land East End

East End / High Rock, Grand Cayman

MLS# 417049

**CI\$350,000**

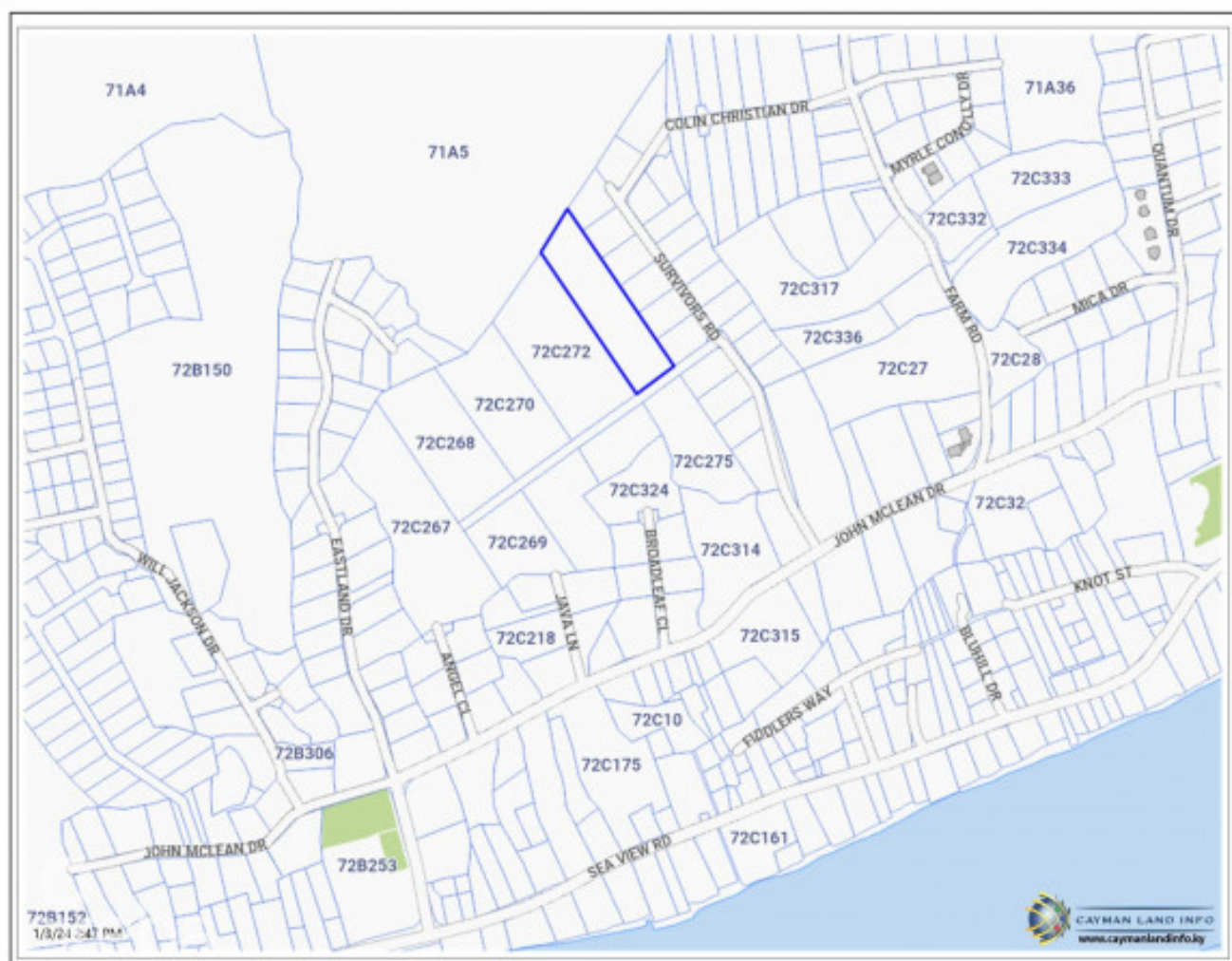

**ALISTER AYRES**

345-946-7888

alister@cip.realestate

Residential developable land north of John McLean Drive generally 5ft above sea level. Suitable for subdivision into seven house lots or 36 apartments

## Essential Information

Type  
**Land**

Status  
**Current**

MLS#  
**417049**

Listing Type  
**Med Density  
Residential**

## Key Details

Width  
**140**

Depth  
**540**

Acreage  
**1.81**

View  
**Garden View**