



256 Crighton Building, Crewe Rd, PO BOX 1977,
Grand Cayman, KY1-1104, Cayman Islands
Phone: +1 (345) 949-7099
Fax: +1 (345) 949-6819
Email: info@cireba.com

The Woodlands - 1 Bed (greenheart Unit 12 End Unit)

Midland East, Grand Cayman

MLS# 415855

CI\$245,000

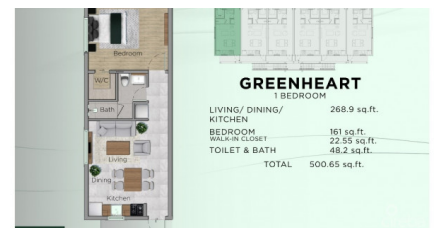

GREENHEART

LIVING/ DINING/ KITCHEN	268.9 sq. ft.
BEDROOM	161 sq. ft.
WALK-IN CLOSET	22.55 sq. ft.
TOILET & BATH	48.2 sq. ft.
TOTAL	500.65 sq. ft.



MARK GAUS
 345-946-9961
 mark.gaus@remax.ky

Woodlands is a new development in up in coming Frank Sound. Woodlands is an extraordinary place to call home, our vibrant town home community is an exciting sophisticated level of class for an elevated living experience with smart technology in mind. Woodlands is located close to Health City, Botanic Park, Clifton Hunter School, Fosters Supermarket as well as various restaurants to make living here a dream. World famous Rum Point, Kaibo and Starfish Point are only minutes away while you enjoy a scenic drive.

Our one and two bedroom residences are pet friendly, family friendly and provide professionals with easy access to the medical gateway of Health City as well as nearby hot spots for fun and relaxing downtime. You can also rest assured in the hurricane protection of these homes that will be fully equipped with hurricane impact windows and doors as well as a standing seam metal roof.

From an impressive variety of floor plans to an upgraded amenities package with a refined touch, youll appreciate our above-and-beyond approach to offering an affordable, quality home that perfectly fits your lifestyle.

Woodlands is brought to you by the developers of: The Blossoms, Lilac Villas and Beach Bay Heights among other residential and commercial projects throughout Grand Cayman. This community consists of 33 units in six different buildings named after six uniquely indigenous trees names found in Cayman. Estimated completion is May 2024. Inquire today for a Sales Brochure.

Essential Information

Type Residential	Status Current	MLS# 415855	Listing Type Condominiums
----------------------------	--------------------------	-----------------------	-------------------------------------

Key Details

Bed 1	Bath 1
-----------------	------------------

View
Garden View, Inland

Year Built 2024	Sq.Ft. 500	Pets Allowed: Yes
---------------------------	----------------------	-----------------------------

Additional Feature

Den No	Furnished Partially
------------------	-------------------------------

Property Feature

Yes

Fenced Yard

Yes

Pool