



256 Crighton Building, Crewe Rd, PO BOX 1977,  
Grand Cayman, KY1-1104, Cayman Islands  
Phone: +1 (345) 949-7099  
Fax: +1 (345) 949-6819  
Email: info@cireba.com

## Brac Land .26 Acre With 30ft Vehicle Access Registered/ Electricity On Road

Cayman Brac Centre, Cayman Brac

MLS# 411582

**CI\$39,000**

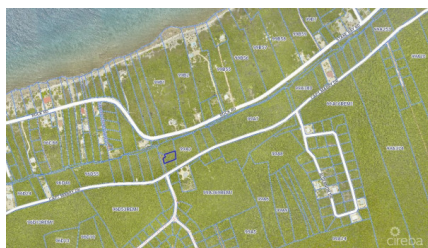

**AMBER YATES**

345-623-2100

amber@c21cayman.com

This land sits on the North side Bluff some 35 ft above sea level. Stake Bay area. This piece of land is close to amenities and civilization with electricity in place along the road, There is a registered 30ft vehicular right of way over 99A363 in favor of this parcel. Image source: www.caymanlandinfo.ky

### Essential Information

Type  
**Land**

Status  
**Current**

MLS#  
**411582**

Listing Type  
**Low Density  
Residential**

The information contained herein has been furnished by the owner and or their nominee and represented by them to be accurate. The listing company, agent and CIREBA MLS disclaims any liability or responsibility for any inaccuracies, errors or omissions in the represented information and all the information contained herein is subject to errors, omissions, price changes, prior sale or withdrawal, without notice and is at all times subject to verification by the purchaser.

## Key Details

Width  
**140**

Depth  
**87**

Acreage  
**0.26**

View  
**Garden View**