



256 Crighton Building, Crewe Rd, PO BOX 1977,
Grand Cayman, KY1-1104, Cayman Islands
Phone: +1 (345) 949-7099
Fax: +1 (345) 949-6819
Email: info@cireba.com

Grand Hyatt Beachfront 2br

Seven Mile Beach, Grand Cayman

MLS# 418015

US\$3,150,000

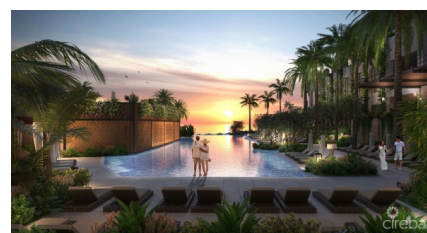
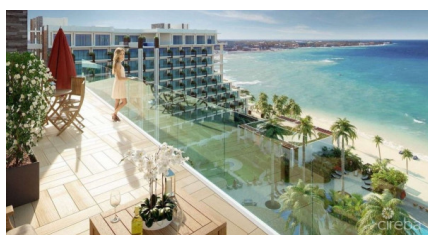
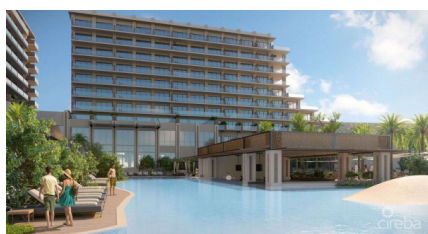

KIM LUND
345-949-9772
kim.lund@remax.ky

Amazing high floor level for absolutely stunning views across the lushly landscaped grounds, Seafront pool and beach area, and the whole southern coastline of Grand Cayman all lit up at night. This wide residence has both bedrooms and the living room/dining room right on the beachfront, each with its own private terrace. There are three full bathrooms, ideal for any overflow guests staying in the living room. Perfect for an owners occasional use and to realize strong rental income. There is a vast array of 5 Star facilities include resort pools, Jacuzzi, sandy ocean lagoon, world class Spa and fitness facility, VIP lounge, 6 restaurants and bars, room service, Kids Club, concierge services, watersports, dive shop, snorkeling, private screening room, 24 hour front desk and security, valet service, and much more. 2 bedroom residences are rarely available for sale at the Grand Hyatt and by far, this location with the high floor level and views is one of the best!

Essential Information

The information contained herein has been furnished by the owner and or their nominee and represented by them to be accurate. The listing company, agent and CIREBA MLS disclaims any liability or responsibility for any inaccuracies, errors or omissions in the represented information and all the information contained herein is subject to errors, omissions, price changes, prior sale or withdrawal, without notice and is at all times subject to verification by the purchaser.

Type
Residential

Status
Current

MLS#
418015

Listing Type
Condominiums

Key Details

Bed
2

Bath
3

View
Beach Front

Year Built
2025

Sq.Ft.
2,247

Pets Allowed:
No

Additional Feature

Den
No

Floor Level
8

Furnished
No