

Hidden Valley House Lot

Midland East, Grand Cayman

MLS# 418040

CI\$135,000

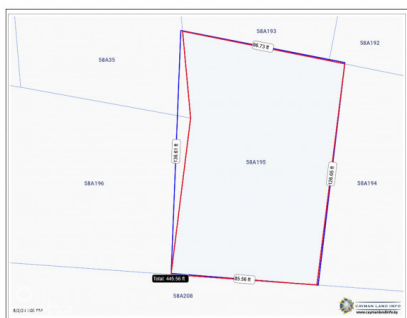

STEVE PARSONS

345 949-5916

steve@propertypals.ky

READY TO GO! This lot is filled, level and all utilities are in place. Beautiful, brand new subdivision, high and dry. Get your house plans ready and realize you dream of home ownership.

Essential Information

The information contained herein has been furnished by the owner and or their nominee and represented by them to be accurate. The listing company, agent and CIREBA MLS disclaims any liability or responsibility for any inaccuracies, errors or omissions in the represented information and all the information contained herein is subject to errors, omissions, price changes, prior sale or withdrawal, without notice and is at all times subject to verification by the purchaser.

Type
Land

Status
Pen/Con

MLS#
418040

Listing Type
**Low Density
Residential**

Key Details

Width
90

Depth
126

Acreage
0.26

View
Garden View