

## (31 Acres) 56 Bluff Edge Development Parcels At 150ft. The Highest Point In The Cayman Islands.

Cayman Brac East, Cayman Brac

MLS# 418205

**CI\$1,995,000**

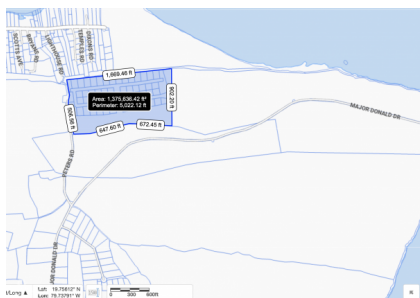

**ANDREW GILBERT**  
andrew@irg.ky

A fantastic one-of-a-kind opportunity to acquire a 31 acre parcel right on the Bluff Edge, already split into 56 subdivided house plots ranging from 0.23-0.43 acres in size and with direct access off Peters Road.

There is nothing else like this on the Bluff Edge which allows someone to come in and develop with the most elevated views in the Cayman Islands at 150ft. This is the single highest point in all of the Cayman Islands.

This land also attaches to the famous Nature Lighthouse trail allowing future home owners access on their doorstep to the beautiful surrounding area.

This opportunity is subject to a future subdivision required from Parcel 111A73 which the Vendors will undertake once an offer is accepted.

Images provided by Lands & Survey

## Essential Information

Type  
**Land**

Status  
**New**

MLS#  
**418205**

Listing Type  
**Little Cayman /  
Cayman Brac**

## Key Details

Width  
**1,669**

Depth  
**902**

Acreage  
**31.00**

View  
**Water View**