



256 Crighton Building, Crewe Rd, PO BOX 1977,
Grand Cayman, KY1-1104, Cayman Islands
Phone: +1 (345) 949-7099
Fax: +1 (345) 949-6819
Email: info@cireba.com

Patrick Island Windswept Dr Canalfront Lot

Prospect/Spotts, Grand Cayman

MLS# 418288

CI\$479,000

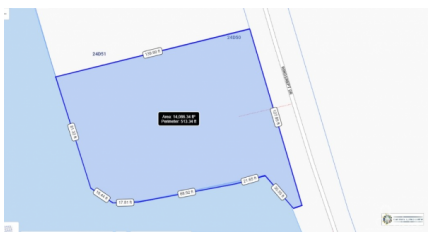
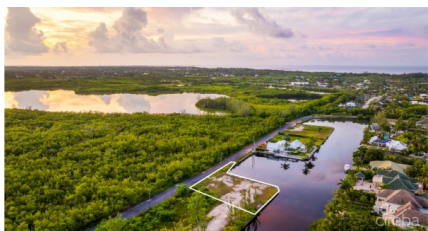

JAMES BOVELL

345-945-4000

james.bovell@remax.ky

This rare parcel has it all – size, location, expansive views & water frontage to two sides! Located in the prominent and established gated community of Patrick’s Island, a Boater’s Paradise. This 0.3230 acre lot features 239 ft. of water frontage providing a rare opportunity to create a property that will benefit from the expansive southwesterly water view.

This lot is perfect for building your own private estate. Provides additional security, privacy, stone seawall and also the best feature is it offers protection for your yacht or multiple boats on both sides of the canal.

Many of the lots in this phase of Patrick’s Island have been developed with wonderful homes in the range of 3,000 sq. ft. up to 10,000 sq. ft. as well as mini estates.

Call us now for more info!

Essential Information

The information contained herein has been furnished by the owner and or their nominee and represented by them to be accurate. The listing company, agent and CIREBA MLS disclaims any liability or responsibility for any inaccuracies, errors or omissions in the represented information and all the information contained herein is subject to errors, omissions, price changes, prior sale or withdrawal, without notice and is at all times subject to verification by the purchaser.

Type
Land

Status
Current

MLS#
418288

Listing Type
**Low Density
Residential**

Key Details

Width
102

Depth
140

Acreage
0.32

View
**Canal Front, Canal
View**