



256 Crighton Building, Crewe Rd, PO BOX 1977,  
Grand Cayman, KY1-1104, Cayman Islands  
Phone: +1 (345) 949-7099  
Fax: +1 (345) 949-6819  
Email: info@cireba.com

## Paradise Gardens - House Lot

Savannah / Lower Valley, Grand Cayman

MLS# 418292

**CI\$245,000**

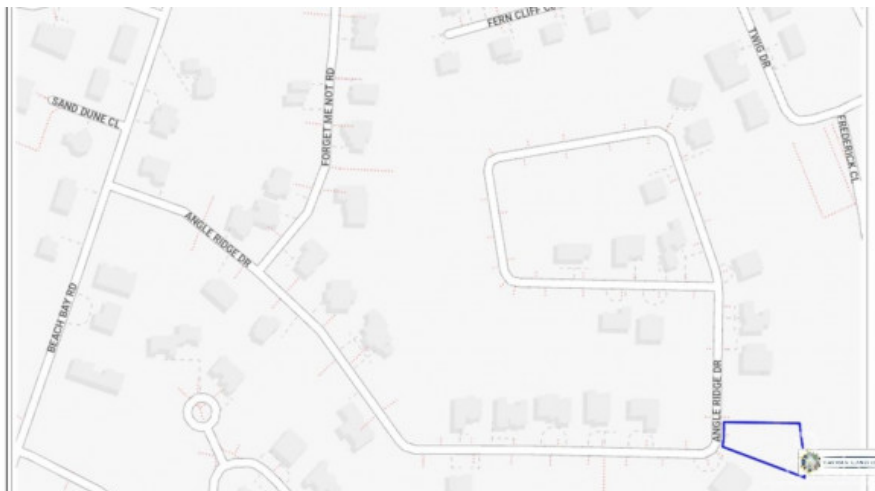

**SUSAN BOYKO**

345-943-7326

susan.boyko@remax.ky

Paradise Gardens is a tranquil community located at the end of Angle Ridge Drive in Lower Valley. It's an emerging community of single residential homes with plans for a community park within the subdivision. This is the ideal place to raise your family in a peaceful environment. The .3109-acre lot for sale is cleared with fill and widens towards the back, making it the perfect spot for a pool!

## Essential Information

Type  
**Land**

Status  
**Current**

MLS#  
**418292**

Listing Type  
**Low Density  
Residential**

## Key Details

Width  
**83**

Depth  
**170**

Acreage  
**0.31**

View  
**Garden View**