



256 Crighton Building, Crewe Rd, PO BOX 1977,  
Grand Cayman, KY1-1104, Cayman Islands  
Phone: +1 (345) 949-7099  
Fax: +1 (345) 949-6819  
Email: info@cireba.com

## Grand Hyatt Beach Resort - 1br Beachfront Corner

Seven Mile Beach, Grand Cayman

MLS# 418450

**US\$3,850,000**

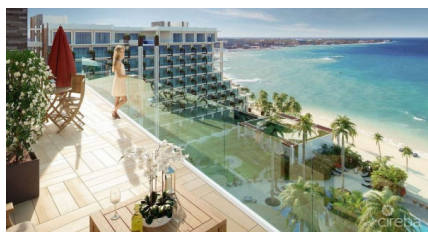
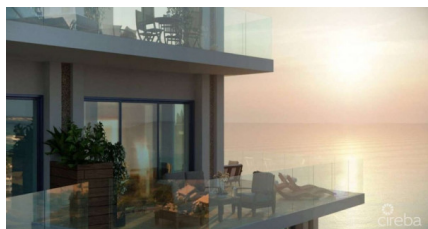

**KIM LUND**  
345-949-9772  
kim.lund@remax.ky

Located at one of the most sought after beachfront corners featuring 2 incredible beachfront terraces - one oversized terrace looks directly out to the beach and Caribbean Sea with amazing sunsets all year long and the other looking all the way up the Seven Mile Beach coastline. Absolutely stunning views! Full kitchen included and washer/dryer. This unique one bedroom Residence features a separate beachfront living room with dining area and a separate beachfront bedroom. Both of the rooms have a full bathroom. Ideal residence for owner's occasional use and with this prime location, rental income should be strong. There is a vast array of 5 Star facilities, services, and amenities including resort pools, Jacuzzi, sandy ocean lagoon, world class Spa and fitness facility, VIP lounge, 6 dining venues, bars, Kids Club, concierge services, watersports, dive shop, snorkeling, private screening room, 24 hour room service, front desk and security, valet service, and much more. Truly a tremendous value for this very prestigious residence within a prominent international 5 Star resort brand!

## Essential Information

Type <b>Residential</b>	Status <b>Current</b>	MLS# <b>418450</b>	Listing Type <b>Condominiums</b>
----------------------------	--------------------------	-----------------------	-------------------------------------

## Key Details

Bed <b>1</b>	Bath <b>2</b>
-----------------	------------------

View  
**Beach Front**

Year Built <b>2025</b>	Sq.Ft. <b>1,810</b>	Pets Allowed: <b>Yes</b>
---------------------------	------------------------	-----------------------------

## Additional Feature

Den <b>No</b>	Floor Level <b>8</b>	Furnished <b>No</b>
------------------	-------------------------	------------------------