

Patrick's Island 0.25 Acres, Canal Front Parcel

Prospect/Spotts, Grand Cayman

MLS# 419184

CI\$349,000

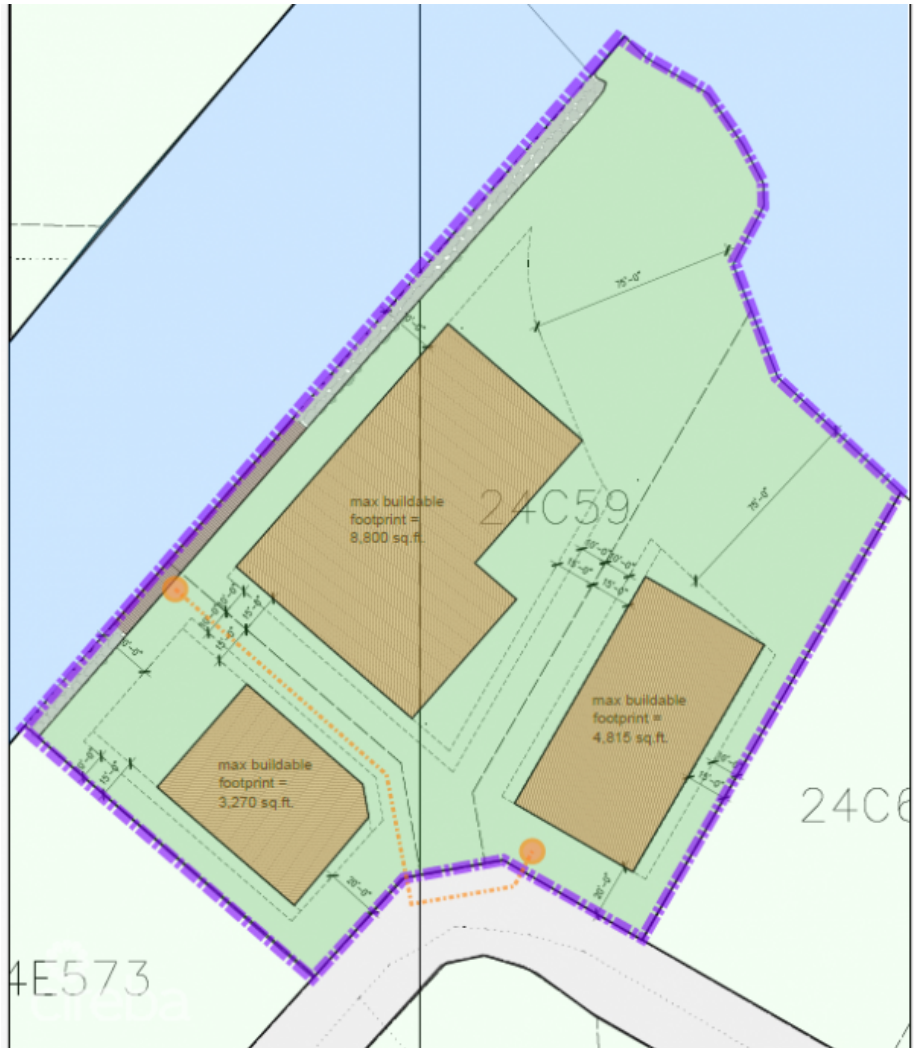
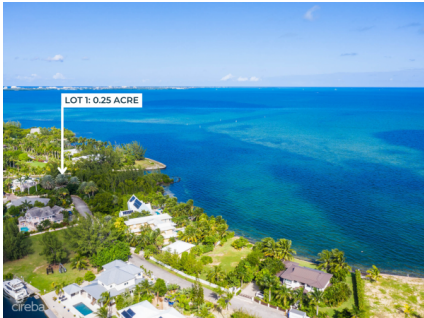

MICHAEL JOSEPH
345-749-4663
michael@propertycayman.com

Situated in the prestigious gated community of Patrick's Island, this canal-front parcel presents an exceptional opportunity to embrace the ultimate boating lifestyle at superb value. With effortless access to the North Sound and peaceful water views, this parcel is a competitively priced home-site for your dream waterfront residence. Subdivision pending, and part agent-owned.

Essential Information

The information contained herein has been furnished by the owner and or their nominee and represented by them to be accurate. The listing company, agent and CIREBA MLS disclaims any liability or responsibility for any inaccuracies, errors or omissions in the represented information and all the information contained herein is subject to errors, omissions, price changes, prior sale or withdrawal, without notice and is at all times subject to verification by the purchaser.

Type Land	Status New	MLS# 419184	Listing Type Low Density Residential
---------------------	----------------------	-----------------------	--

Key Details

Width 80	Depth 140
Acreage 0.25	View Water Front